



The photo shows: the water separator, the burner with the safety cover, the control box, the motor with snap-on connector to the control box



A strong frame and two large pneumatic wheels for an easy ground mobility



A robust hook for crane hanging



A probe senses the temperature: this allows long trouble-free operation. A limit thermostat avoids to reach too high temperatures



Long removable handles allow easy ground mobility



Two flexible tubes diameter 12" (305 mm) can be connected



Front view with 2 outputs. The front cone can be with 2 outputs diameter 12" (300 mm) or with one output diameter 16" (400 mm)



Front view with 1 output. The front cone can be with 2 outputs diameter 12" (300 mm) or with one output diameter 16" (400 mm)

ACCESSORIES



1-way outlet 16" (400 mm)
Code 4033.976



1x16" (407 mm) flexible 7,6 m hose - code 4031.401
1x12" (305 mm) flexible 7,6 m hose - code 4515.553



Room thermostat TH 5
with cable 10 m
Code 4150.112



Digital room thermostat TH D
with cable 5 m
Code 4150.106

BV 500 DIMENSIONS

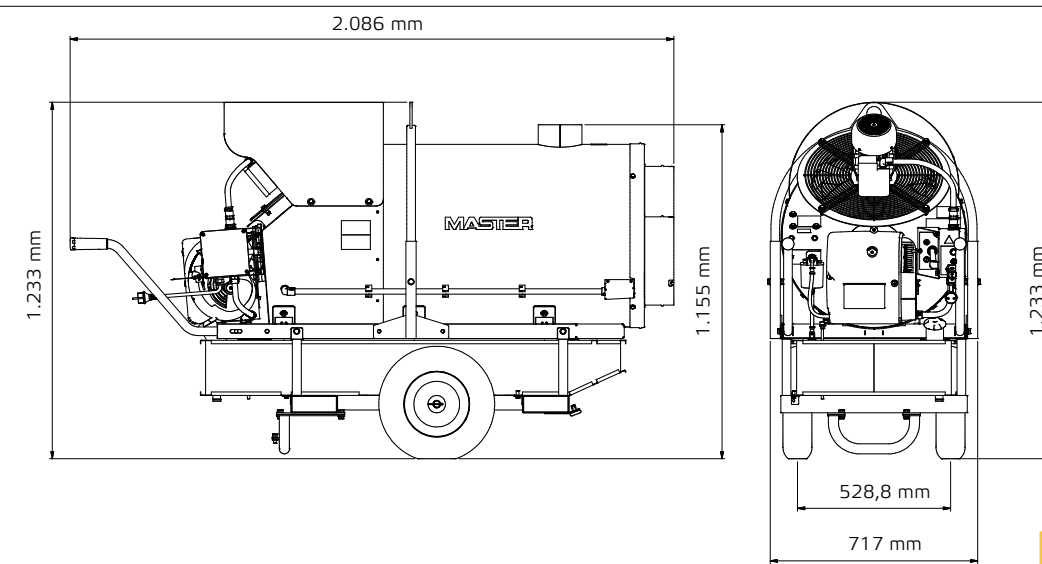

BV 500
Indirect fired heater



FOR:

- Constructions
- Events
- Emergency
- Agriculture
- Military



BV 500

Indirect fired heater

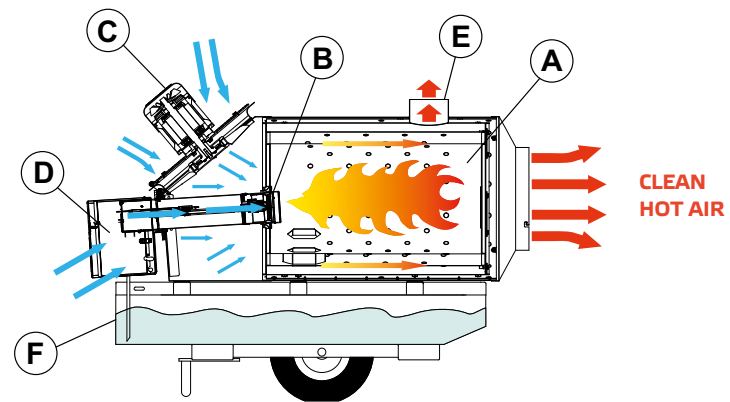

- A** Combustion chamber in stainless steel
- B** Nozzle
- C** Motor
- D** Riello burner
- E** Exhaust hose
- F** Tank

SPECIFICATIONS		BV 500-13C	BV 500-13CR
Fan		Axial	Centrifugal
Total Air Pressure	Pa	443	770
Ductability	m	30	50
Air displacement	m ³ /h	7.700	5.000
Power Fan Motor	W/rpm	1.500/2.750	2.000/1.600
Air Outlet		2 of 12" (300 mm) and 1 of 16" (400 mm)	2 of 12" (300 mm) and 1 of 16" (400 mm)
Maximum Heating Power	kW	150	150
	Btu/h	500.000	500.000
	kcal/h	126.000	126.000
Standard Heating Power	kW	135	135
	Btu/h	450.000	450.000
	kcal/h	110.000	110.000
Outlet Temperature Rise	°C	75	75
Maximum Air Temperature	°C	95	95
Max Nozzle	GPH	Steinen 2,75	Steinen 2,75
Standard Nozzle	GPH	Steinen 2,50	Steinen 2,50
Diesel Pressure	Bar	12	12
Remote thermostat		yes: analog or digital	yes: analog or digital
Flue tube	mm	150	150
Protection	IP	IP 43	IP 43
Fuel Tank Capacity	l	150	150
Max Fuel Consumption	l/h	13,32	13,32
Standard Fuel Consumption	l/h	12,19	12,19
Rated current	A	13	14
Power supply	V/Hz	230/50	230/50
Net weight	kg	224	230
Dimensions	mm	2.086 x 717 x 1.233	2.086 x 717 x 1.233



Welding performed by robots and 100% inspected



BV 500 has windows which allow an easy access to the heat exchanger for cleaning



Control panel including: on/off switch with light messenger, reset button, socket for remote thermostat: analog or digital



Dewatering unit: it eliminates water from the fuel. The fuel is then pre-heater within the combustion head



A leakless fuel tank closure and a big fuel level indicator



BV 500 can be tilted for a comfortable access to the burner and to the electronic control panel



Tilting for easy access to the burner



When required, in case of relevant change of altitude, it is very easy to adjust the combustion



The motor is connected to the electronic panel with a snap-on connector, allowing an easy maintenance

